



xpression
ducted systems



Turn to the Experts

Ultimate in Total Comfort

Ducted air conditioning gives you total climate comfort with the convenience and flexibility to cool and heat your home just how you like it, all year round.

At Carrier we understand the long-term investment of purchasing ducted air conditioning; buying Carrier gives you years of comfort for you and your family. You can depend on your Carrier Factory Authorised Dealer to give you the best possible system for your home.



Summer Cool and Winter Warmth

Carrier ducted systems provide cooling, dehumidification and heating whilst filtering the air. This creates the perfect indoor climate year round in your home. You can be warm and snug in winter and delightfully cool in summer.



The ducted system draws air through the return air grille. The air is automatically filtered and then passed through a refrigeration coil, which either heats or cools the air. The conditioned air is transferred into the ducting and out through streamlined grilles to your rooms.

During summer, the heat from the air inside your home is absorbed and dissipated outside. The dehumidification effect reduces the moisture content in the air for even greater relief on those hot and sticky days.

Energy Efficient and Superior Design

Carrier reverse cycle ducted air conditioning is up to three times more energy efficient than conventional electric heating. So not only will you have year round comfort, but it's cost effective too.

Carrier's advanced computer design technology ensures each system component is perfectly matched for optimum performance and energy efficiency.

Heating System & Efficiency

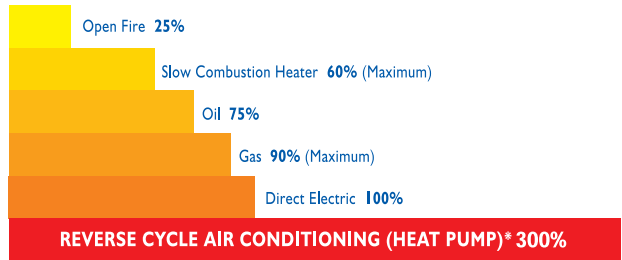

*Heat Pump heating output is reduced below 5°C.

Source: The Earth Exchange.

Exceptional Service and Warranty

When you purchase Carrier you have the satisfaction of knowing you've purchased a premium quality product.

All Carrier residential ducted air conditioning systems carry a comprehensive 5 year parts and labour warranty.



Carrier also offers unequalled service and support with the largest service network in Australia. So you can rest assured that your Carrier ducted air conditioning system will be

serviced by specially trained and accredited service technicians for the life of your system, no matter where you are in Australia.



QPA Xpression Series

The Carrier QPA Xpression series is designed and built in Australia to withstand the extremes of the Australian climate. It will perform in places as varied as the snowfields in sub zero temperatures to the deserts at 50°C.



The Carrier 38QPA Xpression series is the result of over 30 years experience in design and testing air-conditioning products in the Australian market. Our Australian factories are continually updating their designs to incorporate the latest technology available using the finest materials. Australian design and manufacture means that Carrier products are made with Australian conditions in mind, so you can be sure you are buying the best, most suitable products, for your application.

The Carrier QPA Xpression series is a highly efficient range of air conditioners, already exceeding the requirements of the Minimum Energy Performance Standards (MEPS) proposed for 2007.

The Carrier QPA Xpression outdoor unit has been designed to minimise noise levels and is significantly quieter than other air conditioners. It even has a night mode setting to reduce noise further and has additional acoustic options available. These include acoustic compressor hoods that can reduce noise a further 1-2 dBA across the frequency range.

The Carrier QPA Xpression series is built with Australian requirements in mind. The chassis construction is solid yet compact, the condensing unit has an attractive rounded shape, and a choice of indoor fan coil units, allows you to select the right system for your application.

All indoor units feature high power fans that provide smooth, quiet operation yet have the extra capacity needed to provide distribution in larger style applications.

Because this range is made right here in Australia, it already has everything you need to suit typical installations. However, if your application is a little out of the ordinary, we'll have some options that can further customise or tailor the equipment to suit your needs.

These include acoustic options, as well as a range of mechanical and anti-corrosion options to suit coastal or sites with less than ideal ambient environments.



The indoor coil units are available in three configurations (Xtrordinair 40QXA, Low Profile 40QPA and Low Profile Splittable 40QPA-S) giving you greater flexibility in the positioning of this unit, whether it be in the roof or under the floor.

Splittable Indoor Fan Coil Unit (FCU)

Functionality and practicality; two of the outstanding features of the splittable range of the 40QPA Fan Coil Units. Available in the 15, 18, 21 and 24kW sizes, the splittable FCU's give you much more flexibility than the traditional one piece machines. The splittable FCU range comes assembled, but can simply be split on site to facilitate tricky or tight installation applications that are prevalent in today's market.

The splittable FCU range can be broken down into two components, the fan section and the coil selection. This allows you the flexibility to lift the two pieces separately causing less strain on the installer, then the individual components can be re-assembled insitu or installed separately. For example where there is insufficient space to install one large indoor unit, the splittable FCU can be installed as two separate components, and interconnected by flexible duct work. The high static fan capability of this range affords the installer a broader choice in the placement of components, whether assembled as one piece, or installed apart. The splittable comes complete with two interconnecting panels and 4 spigots ready for installation. Maximum flexibility equals maximum choice whatever your application.



40QPA-S series

Control

The QPA series can be controlled with a variety of Carrier thermostats including the NC-4, a revolutionary thermostat for reverse cycle air conditioning. This thermostat is fully programmable with an easy to read LCD, operational status information, fault reporting and "kiddie" lock. Multiple NC-4 thermostats can be installed to give you control of the system from more than one room.



If you want the ultimate in climate control, then the Carrier Comfort Zone is the system for you.

Thermostats

(Non-programmable) Wall Control

Comfort One provides an easy to use wall control, so you can adjust the temperature manually.

- Compact on/off system control
- Fan only switch
- Auto change over from heating to cooling
- Battery Free
- Clean Filter Indicator



(Programmable) Wall Control

Comfort Two is a fully programmable wall control with a seven day timer, for total comfort every day. Adaptive intelligence (smart start) turns the system on in time to reach your set temperature at the set time.

- Energy saving program
- program up to four individual time periods per day on each day of the week
- Auto change over from heating to cooling
- Battery Free
- Clean Filter Indicator



Comfort Zone™ II

(Advanced programmable) Wall Control

Comfort Zone™ II is the ultimate in prestigious climate control for your home. It enables you to program up to eight zones with individual time and temperature settings throughout your home for absolute comfort. Carrier's Comfort Zone™ II control saves up to 30% system energy consumption over other controller systems. You can tailor your air conditioning to suit the precise requirements of your home.



Comfort Zone™ II Wall Control

Zoning

A Carrier Comfort Zone system allows you to customise your indoor weather according to the demands of your home and your lifestyle. Even similar homes have different comfort needs. Your work schedule, the size of your family and many other variables make your requirements unique. That's where zoning fits in. Zoning allows you to take control of your indoor weather and maximise the performance of your comfort system.

Efficient Climate control with Carrier

Comfort Zone

By delivering conditioned air only to areas that are in use, a zoning system eliminates the needless waste of keeping unused areas comfortable. In fact, the systems can actually pay for itself with the money you'll save on your utility bills.

Your Carrier Factory Authorised Dealer can help estimate the cost savings you can expect.



8 Zoning Points & Controller System

Customised Climate Control

The Carrier Comfort Zone system gives you the ability to create up to eight heating and cooling zones in your home.

This gives you the flexibility to customise your comfort system. Here's an example of how to divide a two-story home into five zones.

Zone 1: The kitchen & family room, make a perfect combination for zoning control.

Zone 2: A Second zone on the main floor might include all living areas.

Zone 3: The next zone is the master bedroom and bathroom.

Zone 4: A little-used guest bedroom, a home office or a play room could make up a fourth zone on the main floor.

Zone 5: In this example, zone five becomes the entire upstairs - the kid's bedroom, the bathroom and the hallway.

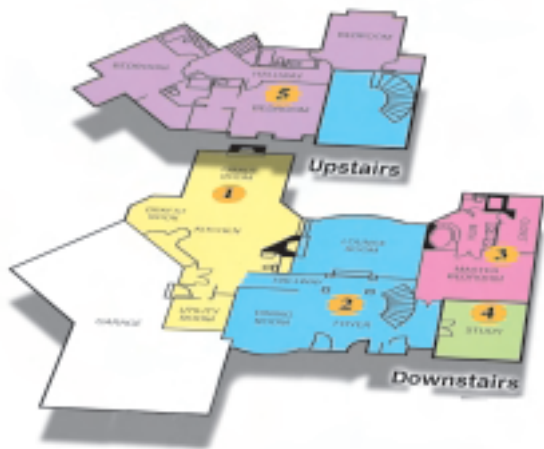

Air Conditioning Checklist

When buying a zoned air conditioning system make sure you check off that the system has the following important features:

	Carrier	Others
1. High cooling and heating capacity.	<input checked="" type="checkbox"/>	<input type="checkbox"/>
2. Energy efficient, saving you money.	<input checked="" type="checkbox"/>	<input type="checkbox"/>
3. Latest technology for quiet operation.	<input checked="" type="checkbox"/>	<input type="checkbox"/>
4. Compact with advanced heat exchanger technology.	<input checked="" type="checkbox"/>	<input type="checkbox"/>
5. Carrier quality and reliability.	<input checked="" type="checkbox"/>	<input type="checkbox"/>
6. Comprehensive 5 year parts and labour warranty.	<input checked="" type="checkbox"/>	<input type="checkbox"/>
7. Carrier Comfort Zone™ II technology.	<input checked="" type="checkbox"/>	<input type="checkbox"/>
9. Can be tailored to suit the precise requirements of your home.	<input checked="" type="checkbox"/>	<input type="checkbox"/>
10. True VVT (variable volume and temperature) control.	<input checked="" type="checkbox"/>	<input type="checkbox"/>

Specifications

Premium Range Condensing Units - Reverse Cycle (Heat Pump)



Model Name	Outdoor Unit	38QPA06-7	38QPA08-7	38QPA10-7	38QPA10-9	38QPA12-7	38QPA12-9	38QPA15-7	38QPA15-9	38QPA18-9	38QPA21-9	38QPA24-9
Power Requirement	Volts - Phase - Hertz	240 - 1 - 50	240 - 1 - 50	240 - 1 - 50	415 - 3 - 50	240 - 1 - 50	415 - 3 - 50	240 - 1 - 50	415 - 3 - 50	415 - 3 - 50	415 - 3 - 50	415 - 3 - 50
Single Phase Starting Mechanism	Factory Standard Factory Option N/A	Direct on Line N/A	Direct on Line Soft Start	Hard Start Soft Start	N/A Soft Start	Hard Start N/A	N/A N/A	Soft Start N/A	N/A N/A	N/A N/A	N/A N/A	N/A N/A
Compressor Type		Scroll	Scroll	Scroll	Scroll	Scroll	Scroll	Scroll	Scroll	Scroll	Scroll	Scroll
Operating Range* (Outdoor Temperature)	Cooling °C Heating °C	15 ~ 50 -5 ~ 18	15 ~ 50 -5 ~ 18	15 ~ 50 -5 ~ 18	15 ~ 50 -5 ~ 18	15 ~ 50 -5 ~ 18	15 ~ 50 -5 ~ 18	15 ~ 50 -5 ~ 18	15 ~ 50 -5 ~ 18	15 ~ 50 -5 ~ 18	15 ~ 50 -5 ~ 18	15 ~ 50 -5 ~ 18
Nominal Airflow (Eco mode activated below 34.5°C Outdoor Temp.)	Standard L/s Eco mode	850 730	850 730	950 760	950 760	950 760	950 760	1650 1500	1650 1500	1650 1500	1750 1600	1750 1600
Dimensions (HxWxD) mm		830 x 950 x 360	830 x 950 x 360	830 x 1100 x 360	830 x 1100 x 360	830 x 1100 x 360	830 x 1100 x 360	1366 x 1100 x 360	1366 x 1100 x 360	1366 x 1100 x 360	1366 x 1100 x 360	1366 x 1100 x 360
Net weight	kg	87	90	107	107	110	110	136	136	138	154	158
Sound Power Level	Standard dBA Eco mode	66.00 64.00	66.00 64.00	66.00 64.00	66.00 64.00	66.00 64.00	66.00 64.00	67.00 65.00	67.00 64.00	67.00 65.00	70.10 68.50	70.20 69.00
Sound Pressure Level	Standard dBA @ 1m Eco mode Standard dBA @ 3m Eco mode	58.00 56.00 48.50 46.50	58.00 56.00 48.50 46.50	58.00 56.00 48.50 46.50	58.00 56.00 48.50 46.50	58.00 56.00 48.50 46.50	58.00 56.00 48.50 46.50	59.00 57.00 49.50 47.50	59.00 56.00 48.50 46.50	59.00 57.00 49.50 47.50	62.10 60.80 52.60 51.00	62.20 61.00 52.70 51.50
Refrigerant Type		R22	R22	R22	R22	R22	R22	R22	R22	R22	R22	R22
Chargeless Length	m	15	15	15	15	15	15	15	15	15	15	15
Maximum Total Equivalent Length	m	50	50	50	50	50	50	50	50	50	50	50
Refrigerant Connection Type		Flare	Flare	Flare	Flare	Flare	Flare	Brazed	Brazed	Brazed	Brazed	Brazed
Refrigerant Connection	Gas mm - inches	15.90 ~ 5/8"	15.90 ~ 5/8"	19.10 ~ 3/4"	19.10 ~ 3/4"	19.10 ~ 3/4"	19.10 ~ 3/4"	28.60 ~ 1 1/8"	28.60 ~ 1 1/8"	28.60 ~ 1 1/8"	28.60 ~ 1 1/8"	28.60 ~ 1 1/8"
Pipe Sizes on Unit	Liquid	9.50 ~ 3/8"	9.50 ~ 3/8"	9.50 ~ 3/8"	9.50 ~ 3/8"	9.50 ~ 3/8"	9.50 ~ 3/8"	9.50 ~ 3/8"	9.50 ~ 3/8"	9.50 ~ 3/8"	12.70 ~ 1/2"	12.70 ~ 1/2"
Refrigerant recommended Pipe Sizes - System	Gas	0 - 15m 16 - 30m	15.90 ~ 5/8" 19.10 ~ 3/4"	15.90 ~ 5/8" 19.10 ~ 3/4"	19.10 ~ 3/4" 22.20 ~ 7/8"	19.10 ~ 3/4" 22.20 ~ 7/8"	19.10 ~ 3/4" 22.20 ~ 7/8"	19.10 ~ 3/4" 22.20 ~ 7/8"	22.20 ~ 7/8" 28.60 ~ 1 1/8"	22.20 ~ 7/8" 28.60 ~ 1 1/8"	28.60 ~ 1 1/8" 28.60 ~ 1 1/8"	28.60 ~ 1 1/8" 28.60 ~ 1 1/8"
	Liquid	0 - 15m 16 - 30m	9.50 ~ 3/8" 9.50 ~ 3/8"	9.50 ~ 3/8" 9.50 ~ 3/8"	9.50 ~ 3/8" 9.50 ~ 3/8"	9.50 ~ 3/8" 9.50 ~ 3/8"	9.50 ~ 3/8" 9.50 ~ 3/8"	9.50 ~ 3/8" 9.50 ~ 3/8"	9.50 ~ 3/8" 9.50 ~ 3/8"	9.50 ~ 3/8" 9.50 ~ 3/8"	12.70 ~ 1/2" 12.70 ~ 1/2"	12.70 ~ 1/2" 12.70 ~ 1/2"
Acoustic Compressor Hood	Option	31 - 50m	✓	✓	✓	✓	✓	Consult local Carrier office for long-line applications		✓	✓	-

System with Xtordinaire Fan Coil Unit

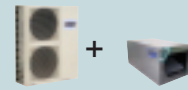

Model Name	Outdoor Unit Indoor Unit	38QPA06-7 40QXA06-7	38QPA08-7 40QXA08-7	38QPA10-7 40QXA10-7	38QPA10-9 40QXA10-7	38QPA12-7 40QXA12-7	38QPA12-9 40QXA12-7	38QPA15-7 40QXA15-7	38QPA15-9 40QXA15-7	38QPA18-9 40QXA18-7
Total System Power Requirement	Phases	Single	Single	Single	Three	Single	Three	Single	Three	Three
Rated Capacity	Cooling	5.90	7.20	9.50	9.50	11.30	11.30	15.10	15.30	17.10
	Heating	5.30	6.60	8.40	8.50	10.30	10.10	13.80	14.00	16.10
Efficiency	Cooling	EER 3.16	2.89	3.22	3.19	2.82	2.84	3.15	3.24	2.98
	Heating	COP 3.44	3.34	3.69	3.60	3.59	3.58	3.59	3.65	3.49
Moisture Removal	L/h	1.35	1.67	2.25	2.19	9.25	9.23	4.89	5.06	5.58
Nominal Airflow	Indoor L/s	350	450	550	550	650	650	750	750	900
Airflow Range	Indoor L/s	245 ~ 385	315 ~ 495	385 ~ 605	385 ~ 605	455 ~ 715	455 ~ 715	525 ~ 825	525 ~ 825	760 ~ 950
ESP @ Nominal Airflow (Hi)	Indoor Pa	220	190	240	240	160	160	220	220	110
Power Supply	Indoor V - Ph - Hz	240 - 1 - 50	240 - 1 - 50	240 - 1 - 50	240 - 1 - 50	240 - 1 - 50	240 - 1 - 50	240 - 1 - 50	240 - 1 - 50	240 - 1 - 50
Motor Shaft Power	Indoor	watts 315	315	400	400	400	400	600	600	600
	Outdoor	watts 6.90	9.00	11.00	5.10	14.40	6.50	18.50	8.70	10.20
Rated Load Current	Indoor	AMPS 4.10	4.10	4.30	4.00	4.00	4.00	4.00	4.00	4.70
	System	AMPS 11.00	13.10	15.30	9.10	18.40	10.50	22.50	12.70	14.90
Full Load Current	System	AMPS 18.80	23.50	25.60	13.30	30.30	15.30	32.20	20.20	20.90
Duct Connection Sizes - Round	Supply air	mm 355	355	406	406	406	406	457	457	508
	Return air	mm 355	355	406	406	406	406	457	457	508
Dimensions	Indoor (HxWxD) mm	430 x 545 x 1100	430 x 545 x 1100	430 x 545 x 1100	430 x 545 x 1100	430 x 545 x 1100	430 x 545 x 1100	535 x 610 x 1190	535 x 610 x 1190	535 x 610 x 1190
Net Weight	Indoor	kg 47	47	50	50	50	50	71	71	71
Refrigeration Connection	Gas	mm - inches 15.90 ~ 5/8"	15.90 ~ 5/8"	19.10 ~ 3/4"	19.10 ~ 3/4"	19.10 ~ 3/4"	19.10 ~ 3/4"	28.60 ~ 1 1/8"	28.60 ~ 1 1/8"	28.60 ~ 1 1/8"
	Liquid	mm - inches 9.50 ~ 3/8"	9.50 ~ 3/8"	9.50 ~ 3/8"	9.50 ~ 3/8"	9.50 ~ 3/8"	9.50 ~ 3/8"	9.50 ~ 3/8"	9.50 ~ 3/8"	9.50 ~ 3/8"
Vertical Fan Coil Unit Configuration	Option	✓	✓	✓	✓	✓	✓	✓	✓	✓

System with Low Profile Fan Coil Unit

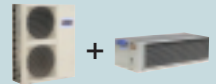

MODEL NO.	Outdoor Unit Indoor Unit	38QPA06-7 40QPA06-7	38QPA08-7 40QPA08-7	38QPA10-7 40QPA10-7	38QPA10-9 40QPA10-7	38QPA12-7 40QPA12-7	38QPA12-9 40QPA12-7	38QPA15-7 40QPA15-7	38QPA15-9 40QPA15-7	38QPA18-9 40QPA18-7	38QPA21-9 40QPA21-7	38QPA24-9 40QPA24-7
Total System Power Requirement	Phases	Single	Single	Single	Three	Single	Three	Single	Three	Three	Three	Three
Rated Capacity	Cooling	5.80	7.20	9.50	9.40	11.10	11.10	15.00	15.20	17.50	21.40	23.80
	Heating	5.30	6.60	8.70	8.60	10.30	10.10	13.90	14.10	16.20	18.80	21.40
Efficiency	Cooling	EER 3.22	3.02	3.10	3.14	3.00	3.02	3.14	3.23	3.14	3.39	3.11
	Heating	COP 3.55	3.48	3.75	3.77	3.84	3.84	3.72	3.78	3.85	4.00	3.82
Moisture Removal	L/h	1.08	1.32	1.53	1.47	1.91	1.85	3.89	4.06	3.33	4.19	4.64
Nominal Airflow	Indoor L/s	350	450	550	550	650	650	750	750	1000	1150	1300
Airflow Range	Indoor L/s	245 ~ 385	315 ~ 495	385 ~ 605	385 ~ 605	455 ~ 715	455 ~ 715	525 ~ 825	525 ~ 825	700 ~ 1100	810 ~ 1265	910 ~ 1430
ESP @ Nominal Airflow (Hi)	Indoor Pa	220	190	190	190	160	160	190	190	210	230	190
Power Supply	Indoor V - Ph - Hz	240 - 1 - 50	240 - 1 - 50	240 - 1 - 50	240 - 1 - 50	240 - 1 - 50	240 - 1 - 50	240 - 1 - 50	240 - 1 - 50	240 - 1 - 50	240 - 1 - 50	240 - 1 - 50
Motor Shaft Power	Indoor	watts 315	400	400	400	600	600	600	600	600	750	750
	Outdoor	watts 6.90	9.00	11.00	5.10	14.30	6.40	18.20	8.70	10.20	11.30	13.40
Rated Load Current	Indoor	AMPS 2.30	2.90	2.90	2.90	2.80	2.80	3.10	3.10	5.00	6.50	6.50
	System	AMPS 9.20	11.80	13.80	8.00	17.10	9.20	21.30	11.80	15.20	17.80	19.90
Full Load Current	System	AMPS 17.00	22.20	24.10	12.10	29.00	14.00	31.30	19.30	21.20	25.50	28.80
Duct Connection Sizes - Rectangular	Supply Air	(W x H) mm 715 x 185	715 x 185	715 x 185	715 x 185	715 x 185	715 x 185	715 x 262	715 x 262	715 x 262	835 x 300	835 x 300
	Return Air	(W x H) mm 820 x 258	820 x 258	1075 x 261	1075 x 261	1075 x 261	1075 x 261	1075 x 387	1075 x 387	1075 x 387	1350 x 404	1350 x 404
Dimensions	Indoor (HxWxD) mm	368 x 1050 x 520	368 x 1050 x 520	368 x 1225 x 580	368 x 1225 x 580	368 x 1225 x 580	368 x 1225 x 580	368 x 1225 x 580	368 x 1225 x 580	368 x 1225 x 580	455 x 1500 x 625	455 x 1500 x 625
Net Weight	Indoor	kg 50	50	54	54	55	55	61	61	66	72	72
Refrigeration Connection	Gas	mm - inches 15.90 ~ 5/8"	15.90 ~ 5/8"	19.05 ~ 3/4"	19.05 ~ 3/4"	19.05 ~ 3/4"	19.05 ~ 3/4"	28.60 ~ 1 1/8"	28.60 ~ 1 1/8"	28.60 ~ 1 1/8"	28.60 ~ 1 1/8"	28.60 ~ 1 1/8"
	Liquid	mm - inches 9.50 ~ 3/8"	9.50 ~ 3/8"	9.50 ~ 3/8"	9.50 ~ 3/8"	9.50 ~ 3/8"	9.50 ~ 3/8"	9.50 ~ 3/8"	9.50 ~ 3/8"	9.50 ~ 3/8"	12.70 ~ 1/2"	12.70 ~ 1/2"

System with 'Splittable' Low Profile Fan Coil Unit



Model Name	Outdoor Unit Indoor Unit							38QPA15-7 40QPA15-7S	38QPA15-9 40QPA15-7S	38QPA18-9 40QPA18-7S	38QPA21-9 40QPA21-7S	38QPA24-9 40QPA24-7S
Total System Power Requirement	Phases							Single	Three	Three	Three	Three
Rated Capacity	Cooling							14.80	15.20	17.50	21.40	23.80
	Heating							13.80	14.10	16.20	18.80	21.40
Efficiency	Cooling							3.12	3.23	3.14	3.39	3.11
	Heating							3.49	3.78	3.85	4.00	3.82
Moisture Removal	L/h							3.89	4.06	3.33	4.19	4.64
Nominal Airflow	Indoor L/s							750	750	1000	1150	1300
Airflow Range	Indoor L/s							525 ~ 825	525 ~ 825	700 ~ 1100	810 ~ 1265	910 ~ 1430
ESP @ Nominal Airflow (Hi)	Indoor Pa							190	190	210	230	190
Power Supply	Indoor V - Ph - Hz							240 - 1 - 50	240 - 1 - 50	240 - 1 - 50	240 - 1 - 50	240 - 1 - 50
Motor Shaft Power	Indoor							600	600	600	750	750
	Outdoor							18.20	8.70	10.20	11.30	13.40
Rated Load Current	Indoor							3.10	3.10	5.00	6.50	6.50
	System							21.30	11.80	15.20	17.80	19.90
Full Load Current	System							31.30	19.30	21.20	25.50	28.80
Duct Connection Sizes - Rectangular (See Notes*)	Supply Air							715 x 262	715 x 262	715 x 262	835 x 300	835 x 300
	Return Air							1075 x 387	1075 x 387	1075 x 387	1350 x 404	1350 x 404
Dimensions (Indoor)	Fan Section Coil Section (HxWxD) mm							427 x 1225 x 435 427 x 1225 x 310	427 x 1225 x 435 427 x 1225 x 310	427 x 1225 x 435 427 x 1225 x 310	455 x 1500 x 435 455 x 1500 x 310	455 x 1500 x 435 455 x 1500 x 310
	Fan Section Coil Section							36 42	36 42	36 42	35 50	35 50
Net Weight	kg							36 42	36 42	36 42	35 50	35 50
Refrigeration Connection	Gas							28.60 ~ 1 1/8"	28.60 ~ 1 1/8"	28.60 ~ 1 1/8"	28.60 ~ 1 1/8"	28.60 ~ 1 1/8"
	Liquid							9.50 ~ 3/8"	9.50 ~ 3/8"	9.50 ~ 3/8"	12.70 ~ 1/2"	12.70 ~ 1/2"

*NOTE: Splittable units are supplied with two (2) Face Panels complete with two (2) 450mm ovalised duct spigots on each. Due to our policy of continuous improvement, product specifications and details are subject to change without notice. Equipment rated in accordance with MEPS AS 3823.3 - 2003 E. & O.E.



Turn to the Experts

34-40 Garden Boulevard, Dingley, Victoria 3172
www.carrieraircon.com.au

Distributed by:

